

HAWAII

*Island of emerald rainforests
and misty waterfalls,
fiery volcanoes and
snow-capped peaks.
Here, the heartbeat
of the ocean
touches sands of black,
white and green.*

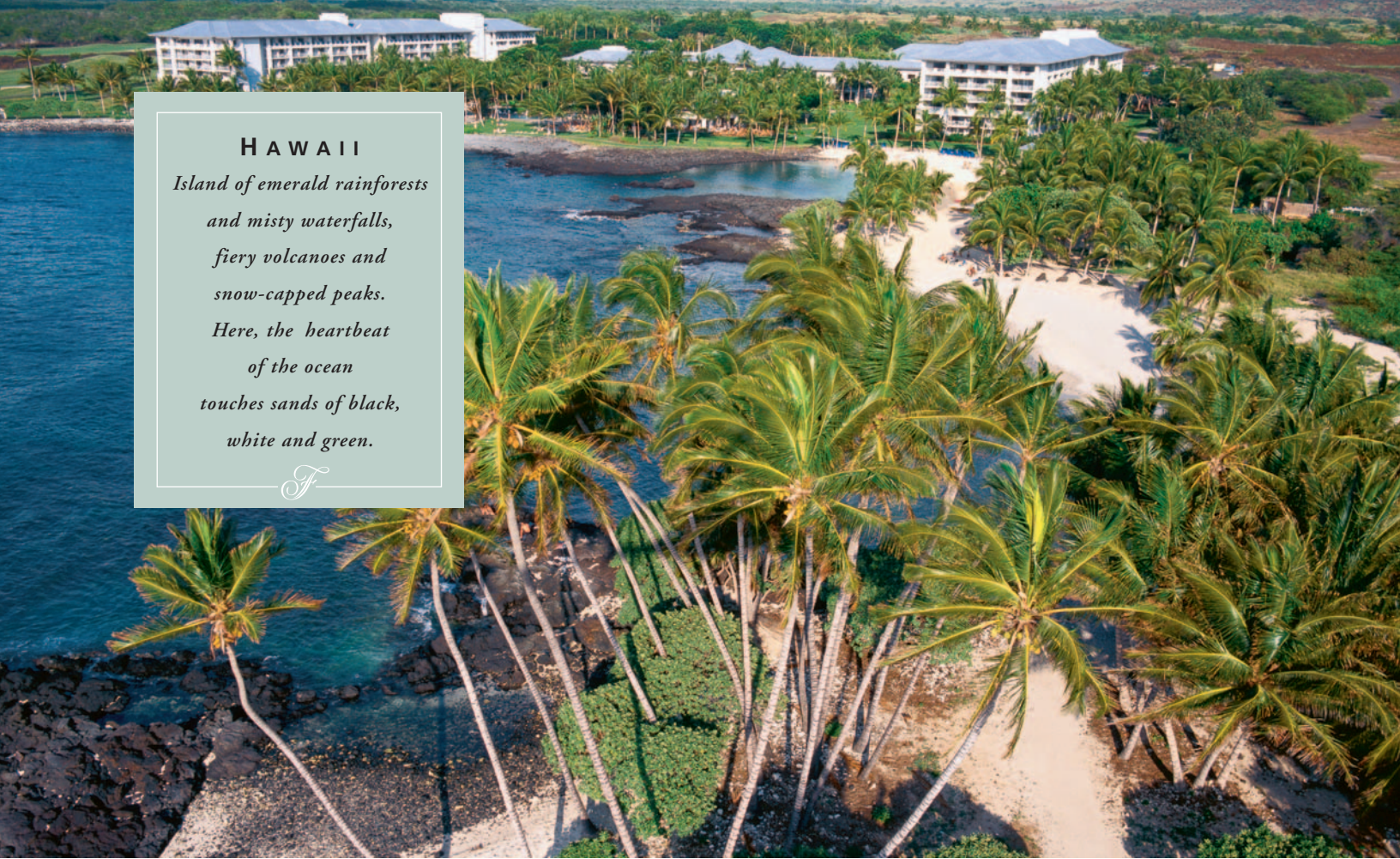

THE FAIRMONT ORCHID

On the sun-drenched Kohala Coast, The Fairmont Orchid is the perfect place to experience the natural wonders of Hawaii and the warmth of aloha. Impeccable weather conditions and 76,000 square feet of open-air space offer unique opportunities for outdoor events. Sprawling oceanfront lawns, secluded beachfront coves and a historic fishpond are extraordinary locations for banquets, sunset dinners and lu'aus. Inside, the resort is elegantly appointed with three ballrooms, each opening on to courtyards and gardens, a full-size amphitheater, seven conference rooms and a traditional boardroom. While our professional catering and conference services staff take care of the details, revitalize with outdoor yoga or massage, snorkel or scuba dive among colorful fish and sea turtles or play a round of golf on the stunning seaside golf courses. The Fairmont Orchid provides countless ways to enjoy the beauty of the surroundings in exceptional luxury and style.

One North Kaniku Drive
Kohala Coast, HI 96743
Phone: 808-885-2000
Fax: 808-885-8886



Garden Level

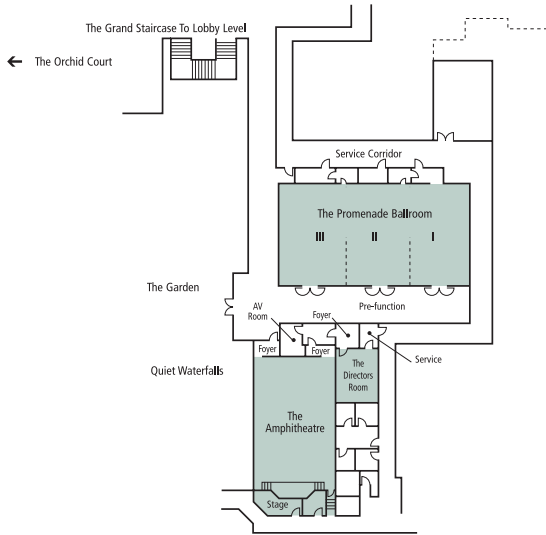

Lobby Level

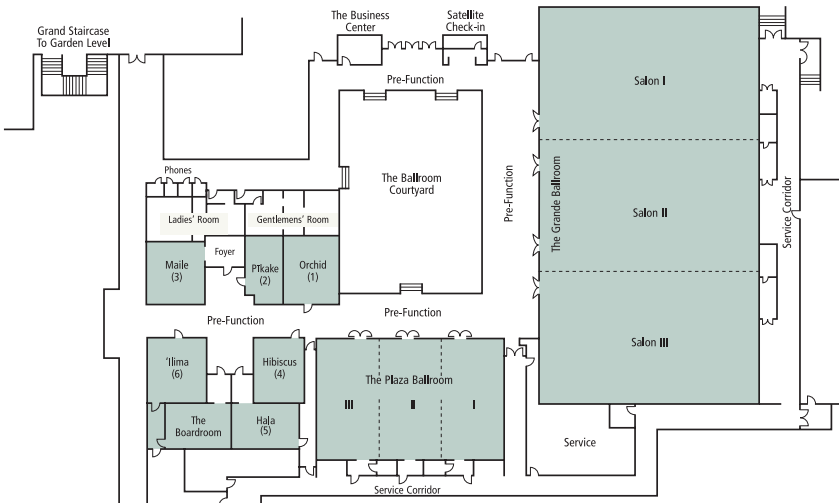

| AVERAGE TEMPERATURES (Celsius/Fahrenheit) | | | |
|--|--------------------|-------|-------|
| | | °C/F | °C/F |
| | | High | Low |
| WINTER | JANUARY - MARCH | 24/76 | 17/63 |
| SPRING | APRIL - JUNE | 26/78 | 18/65 |
| SUMMER | JULY - SEPTEMBER | 27/81 | 20/68 |
| FALL | OCTOBER - DECEMBER | 26/79 | 19/66 |

Annual rainfall: less than 10" per year

ROOMS

- Guestrooms 484
- Suites 54
- All rooms and suites have lanais

FACILITIES

- 32 oceanfront acres
- 76,000 sq. ft. of open air function area
- 32,000 sq. ft of indoor function space
- Business Center
- Fresh water pool (10,000 sq. ft) and sundeck (20,000 sq. ft)
- 2 lava rock whirlpools
- Sheltered white sand lagoon
- 5 restaurants and 4 lounges
- Fitness Center
- Valet parking
- Gift shops
- Spa Without Walls, Hawaii's most beautiful outdoor spa.

ACTIVITIES

- Golf
- Tennis
- Keiki Aloha children's program
- Beachboys program
- Canoe, kayak and catamaran excursions
- Snorkeling and scuba diving
- Guided hikes on Hawaii's forest and mountain trails

LOCAL ATTRACTIONS

- Hawaii Volcanoes National Park
- Parker Ranch
- Mauna Kea Observatory
- Marine Sanctuary of Kealakekua Bay
- Pu'ukohola Heiau

AIRPORT

- Keahole-Kona International Airport (20 miles/32 km)

| ROOMS | SQUARE FEET | DIMENSIONS | RECEPTION | THEATER SEATING | BANQUET SEATING | CONFERENCE SEATING | CLASSROOM SEATING |
|-----------------------------|-------------|----------------|-----------|-----------------|-----------------|--------------------|-------------------|
| GARDEN LEVEL | | | | | | | |
| The Promenade Ballroom | 3,150 | 75 x 42 x 11* | 288 | 261 | 220 | - | 180 |
| The Promenade I, II, or III | 1,050 | 25 x 42 x 11* | 96 | 87 | 70 | 40 | 54 |
| Pre-Function | 972 | - | - | - | - | - | - |
| The Director's Room | 475 | 19 x 25 x 11 | 48 | 44 | 30 | 20 | 28 |
| The Amphitheater | - | - | - | 160 | - | - | - |
| LOBBY LEVEL | | | | | | | |
| The Grande Ballroom | 14,000 | 159 x 88 x 14* | 1,278 | 1,170 | 910 | - | 840 |
| Salon I, II or III | 4,666 | 53 x 88 x 14* | 426 | 390 | 280 | - | 216 |
| Pre-Function & Courtyard | 10,000 | - | 250 | - | 120 | - | - |
| The Plaza Ballroom | 3,600 | 75 x 48 x 12* | 327 | 300 | 240 | - | 220 |
| Plaza I, II or III | 1,200 | 25 x 48 x 12* | 109 | 100 | 80 | 46 | 70 |
| Orchid | 526 | 20 x 26 x 11 | 48 | 44 | 40 | 20 | 27 |
| Pikake | 468 | 18 x 26 x 11 | 43 | 38 | 30 | 18 | 24 |
| Maile | 525 | 21 x 25 x 11 | 48 | 44 | 40 | 20 | 27 |
| Hibiscus | 480 | 20 x 24 x 11 | 43 | 38 | 36 | 18 | 27 |
| Hala | 500 | 20 x 25 x 11 | 48 | 44 | 30 | 20 | 27 |
| Ilima | 550 | 22 x 25 x 11 | 50 | 46 | 42 | 22 | 27 |
| The Boardroom | 496 | 16 x 31 x 11 | - | - | 16 | 16 | - |

*coffered ceiling