

# FAIRMONT ZIMBALI RESORT CONFERENCE CENTRE

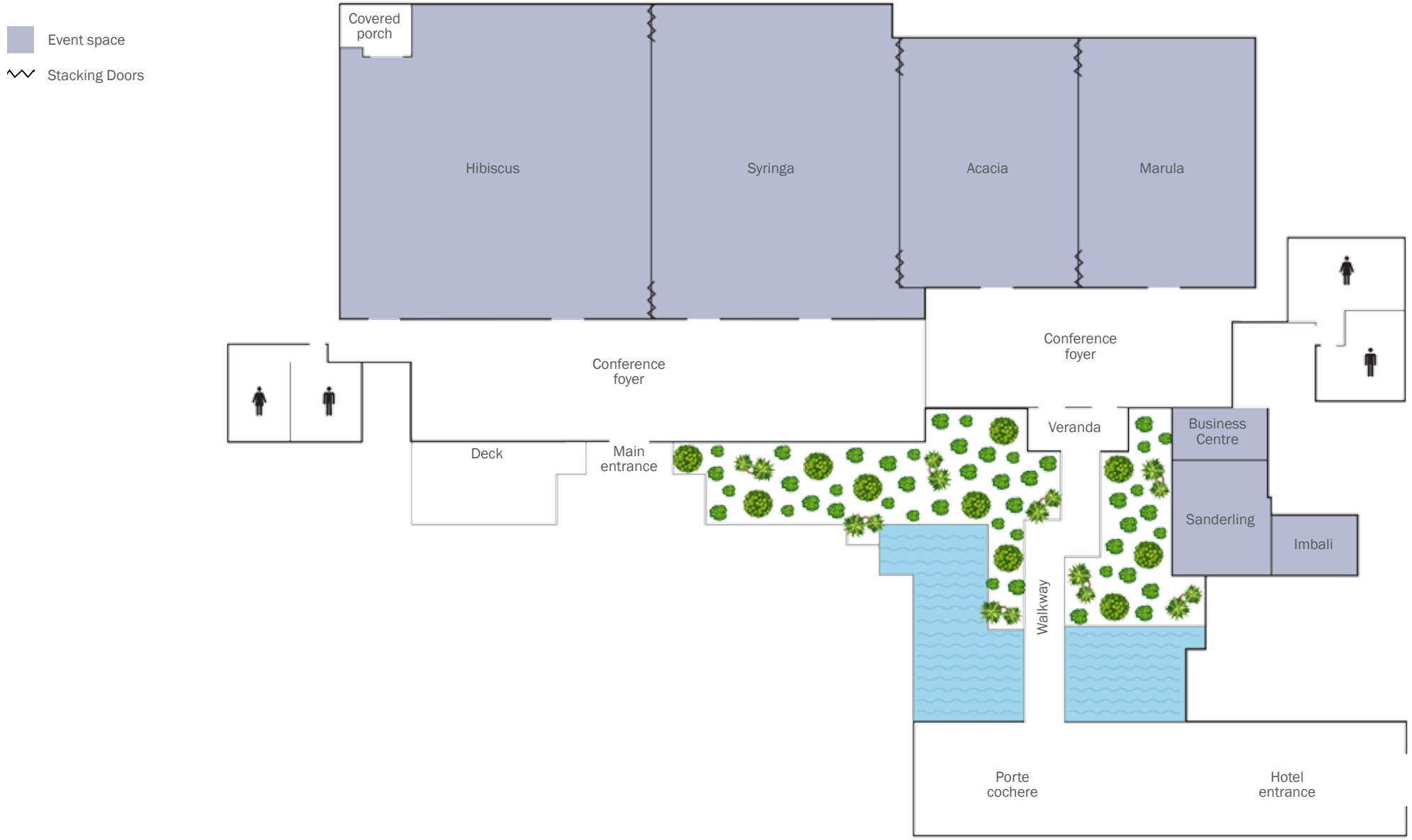







To book your next meeting or event at Fairmont Zimbali Resort, please call + 27 (0)32 538 5000, email [zimbali.sales@fairmont.com](mailto:zimbali.sales@fairmont.com) or visit [fairmont.com/zimbali-resort](http://fairmont.com/zimbali-resort)



Please note that this diagram is for illustrative purposes only and not drawn to scale.

## CAPACITY CHART

	BANQUET	THEATRE	CLASSROOM	BOARDROOM	RECEPTION	U-SHAPE	CABARET
							
Marula	90	120	90	42	120	30	40
Acacia	90	120	90	42	120	30	40
Syringa	160	220	180	66	240	51	80
Hibiscus	200	250	210	72	250	51	110
Foyer					180		
Zimbali Ballroom	540	750	450		600		270
Sanderling		30	20	12		10	
Imbali		15	10	8		7	

PLEASE NOTE: Capacities given only include table & chair seating. Staging, dancefloors, back projection space and podiums are not included.

## MEETING ROOM DIMENSIONS

	DIMENSIONS (m)	SQ (m)	HEIGHT (m)
Marula	10.6 x 12.7	136	5
Acacia	10.3 x 12.7	131	5
Syringa	15.2 x 19	298	5
Hibiscus	18.9 x 19	360	5
Sanderling	6.7 x 5.7	37.7	2.49
Imbali	4.2 x 3.5	32.3	2.20



To book your next meeting or event at Fairmont Zimbali Resort, please call + 27 (0)32 538 5000, email [zimbali.sales@fairmont.com](mailto:zimbali.sales@fairmont.com) or visit [fairmont.com/zimbali-resort](http://fairmont.com/zimbali-resort)



Although every effort has been made to ensure the accuracy of this information, all figures given are estimates and dependent on various factors.