

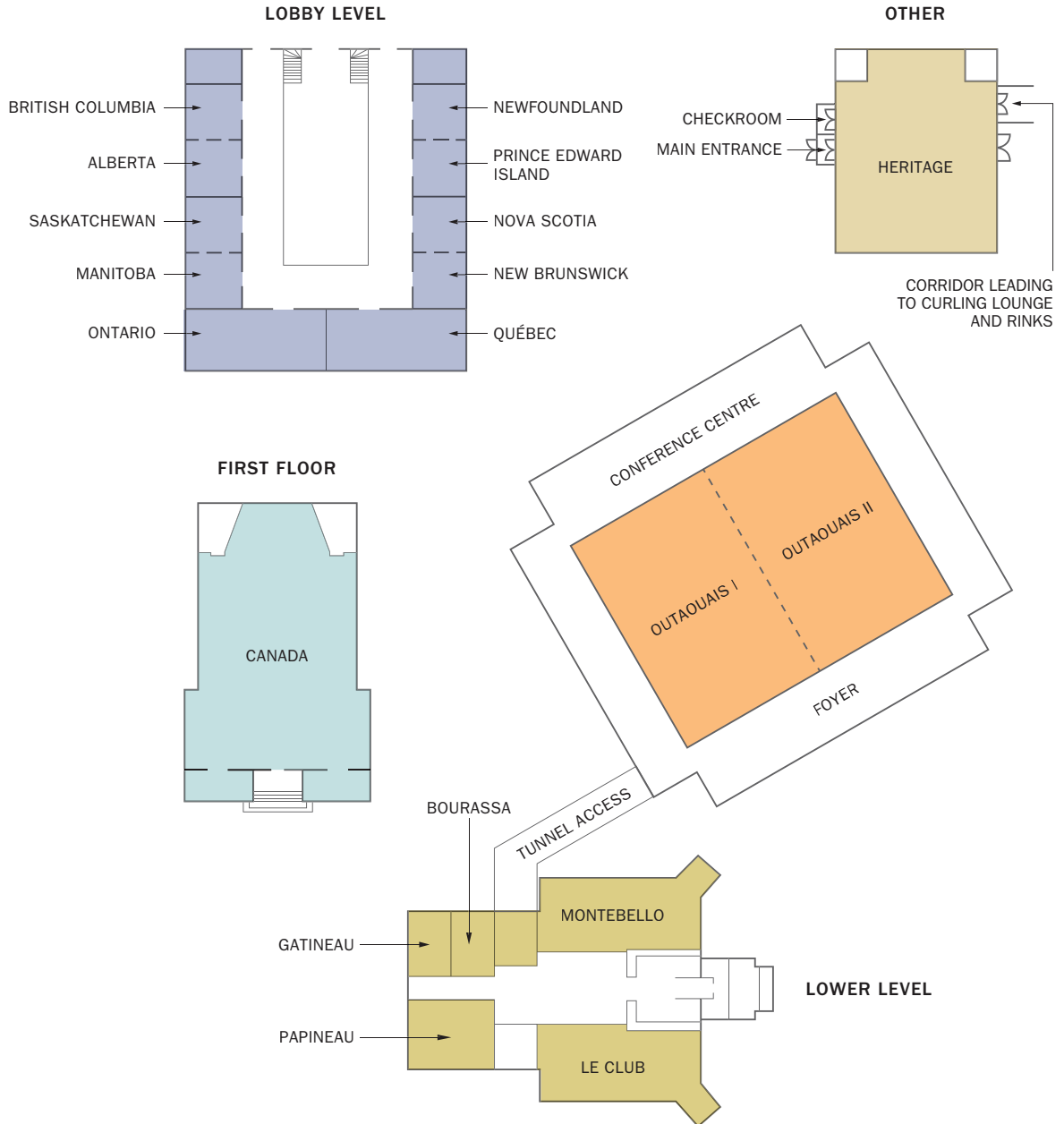

FLOORPLAN



Fairmont Le Château Montebello
392 Rue Notre Dame
Montebello, Québec
Canada J0V 1L0
TEL + 1 819 423 6341
FAX + 1 819 423 1133
chateaumontebello@fairmont.com
fairmont.com/montebello

Fairmont
LE CHÂTEAU MONTEBELLO

CAPACITY CHART

	OVERALL DIMENSIONS		SQUARE		HEIGHT		CAPACITIES							
	FEET	METRES	FEET	METRES	FEET	METRES	BOARD-ROOM	ROUNDS 10	CLASS-ROOM	THEATRE	U-SHAPE	RECEPTION	HOLLOW SQUARE	8' X 8' BOOTH
FIRST FLOOR														
CANADA	58 x 44	17.7 x 13.4	2,911	270.4	20	6.1	52	200	180	250	56/90	300	96	18
MEZZANINE	234 x 14	71.3 x 4.3	5,180	481.2	30	9.1	-	-	-	-	-	175	-	24
LOBBY LEVEL														
NEWFOUNDLAND	15 x 16	4.6 x 4.9	233	21.6	10	3.0	10	10	-	20	10	-	-	-
PRINCE EDWARD ISLAND	15 x 16	4.6 x 4.9	202	18.8	10	3.0	10	10	-	20	10	-	-	-
NEWFOUNDLAND & PRINCE EDWARD ISLAND COMBINED	30 x 16	9.1 x 4.9	455	42.3	10	3.0	24	30	18	40	22	40	24	-
NOVA SCOTIA	15 x 16	4.6 x 4.9	242	22.5	10	3.0	10	10	-	20	10	-	-	-
NEW BRUNSWICK	15 x 16	4.6 x 4.9	253	23.5	10	3.0	10	10	-	20	10	-	-	-
NOVA SCOTIA & NEW BRUNSWICK COMBINED	30 x 16	9.1 x 4.9	495	45.9	10	3.0	24	30	18	40	22	40	24	-
ONTARIO	46 x 17	14.0 x 5.2	690	64.1	10	3.0	38	50	36	65	36	65	38	5
QUÉBEC	46 x 17	14.0 x 5.2	697	64.8	10	3.0	38	50	36	65	36	65	38	5
MANITOBA	15 x 16	4.6 x 4.9	254	23.6	10	3.0	10	10	-	20	10	-	-	-
SASKATCHEWAN	15 x 16	4.6 x 4.9	231	21.5	10	3.0	10	10	-	20	10	-	-	-
ALBERTA	15 x 16	4.6 x 4.9	231	21.5	10	3.0	10	10	-	20	10	-	-	-
MANITOBA & SASKATCHEWAN COMBINED	30 x 16	9.1 x 4.9	484	44.9	10	3.0	24	30	18	40	22	40	24	-
BRITISH COLUMBIA	15 x 16	4.6 x 4.9	231	21.5	10	3.0	10	10	-	20	10	-	-	-
ALBERTA & BRITISH COLUMBIA COMBINED	30 x 16	9.1 x 4.9	461	42.8	10	3.0	24	30	18	40	22	40	24	-
MEZZANINE	77 x 14	23.5 x 4.3	2,840	263.8	20	6.1	-	160	-	-	-	300	-	17
LOWER LEVEL														
GATINEAU	13 x 19	3.9 x 5.7	227	21.1	12	3.7	8	10	-	20	10	-	-	-
BOURASSA	13 x 19	3.9 x 5.7	245	22.8	12	3.7	8	10	-	20	10	-	-	-
MONTEBELLO	21 x 48	6.4 x 14.6	977	90.8	12	3.7	38	70	56	80	40	100	44	10
LE CLUB	21 x 48	6.4 x 14.6	1,040	96.6	12	3.7	38	70	56	80	40	100	44	10
PAPINEAU	26 x 19	7.8 x 5.7	491	45.6	12	3.7	20	30	21	45	18	45	22	-
CONFERENCE CENTRE														
OUTAOUAIS	79 x 53	24.2 x 16.2	4,182	388.7	16	4.9	-	350	250	425	-	500	120	28
OUTAOUAIS I	39 x 53	11.9 x 16.2	2,094	194.5	16	4.9	42	150	120	200	48	-	52	12
OUTAOUAIS II	39 x 53	11.9 x 16.2	2,090	194.2	16	4.9	42	150	120	200	48	-	52	12
FOYER	-	-	2,467	229.2	16	4.9	-	70	-	-	-	320	-	9
OTHER														
HERITAGE	54 x 40	16.4 x 12.1	2,176	202.2	10	3.0	42	150	120	200	48	-	52	12
TENT (SEASONAL)	50 x 82	15.2 x 25.0	4,104	381.3	16	4.9	-	300	250	350	60/100	300	120	-
GOLF CLUBHOUSE	60 x 28	18.3 x 8.2	1,990	184.9	16	4.9	42	100	100	150	48	100	52	-
CURLING LOUNGE	30 x 45	9.1 x 13.4	1,588	147.5	15	4.6	20	60	-	-	18	80	22	-
NUNAVUT (MAY TO OCTOBER)	156 x 36	47.6 x 11.0	7,914	735.2	18	5.5	-	400	320	560	-	500	-	40

DINING CAPACITY FOR GROUPS

	CENTRE	LE RIVERAIN EXTENSION	DIANE EXTENSION
AUX CHANTIGNOLES	150	56	80