

1ST FLOOR

ENTRANCE, LOBBY, LOUNGE & DINING AREAS

AMENITIES

- Reception and Concierge Desk
- Grand Lobby
- Park Lounge and Lobby Bar
- Gourmet Provisions
- 11,726 sf Sound Stage 16
- Dining: Modern American, Pizzeria, Pasta, Asian, Bakery and Small Bites, Charcuterie, Private Dining
- Access to 545 underground parking spaces

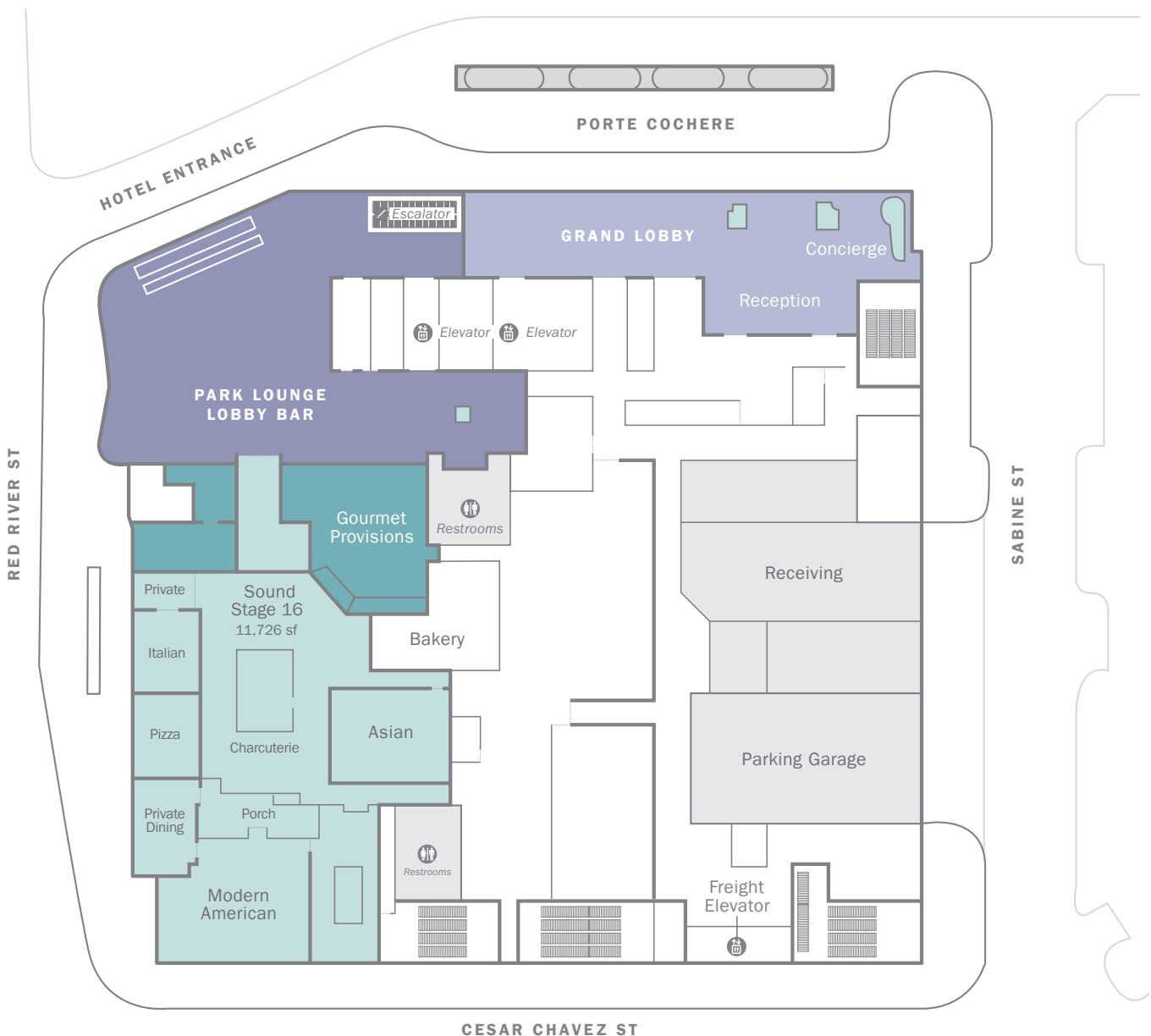

3RD FLOOR

CONGRESSIONAL BALLROOM

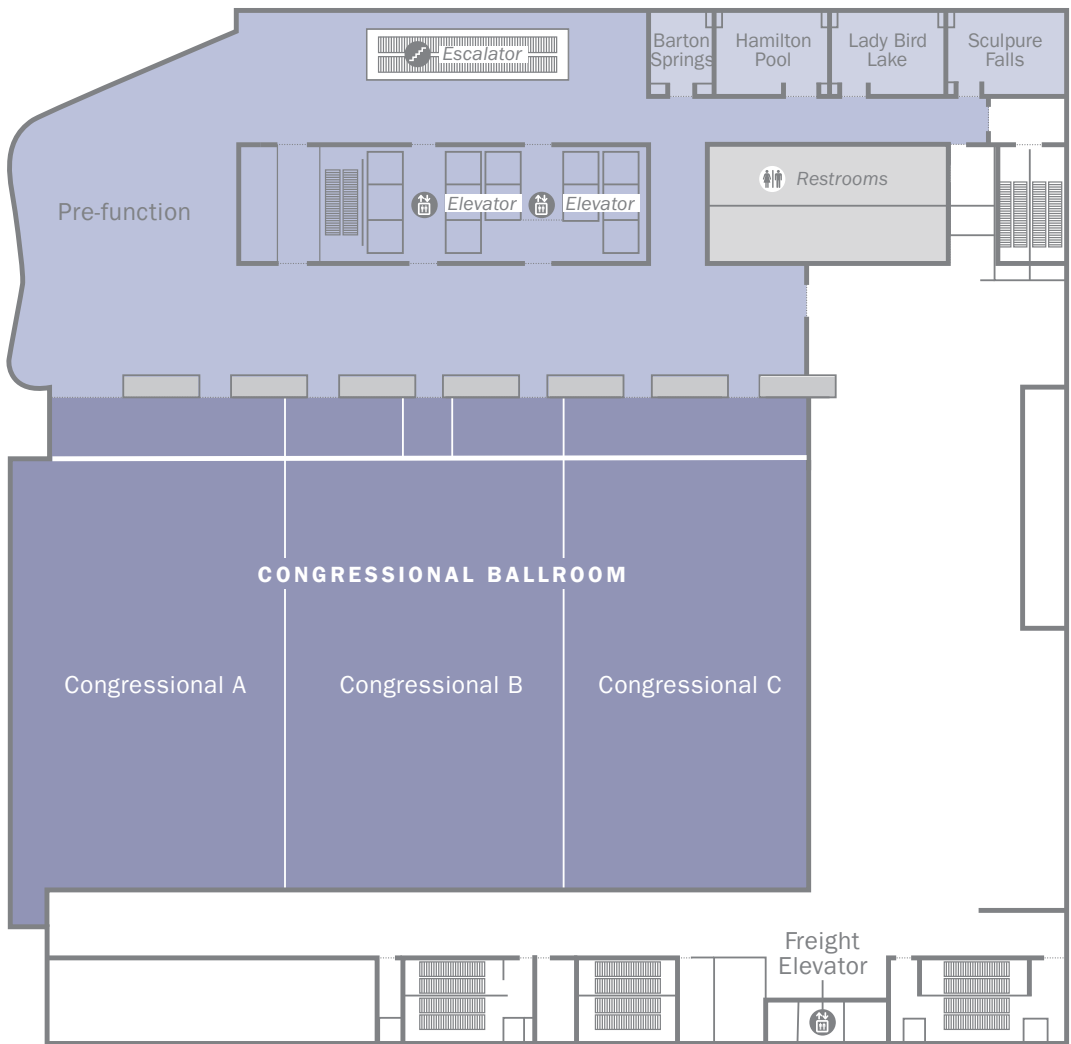

4TH FLOOR

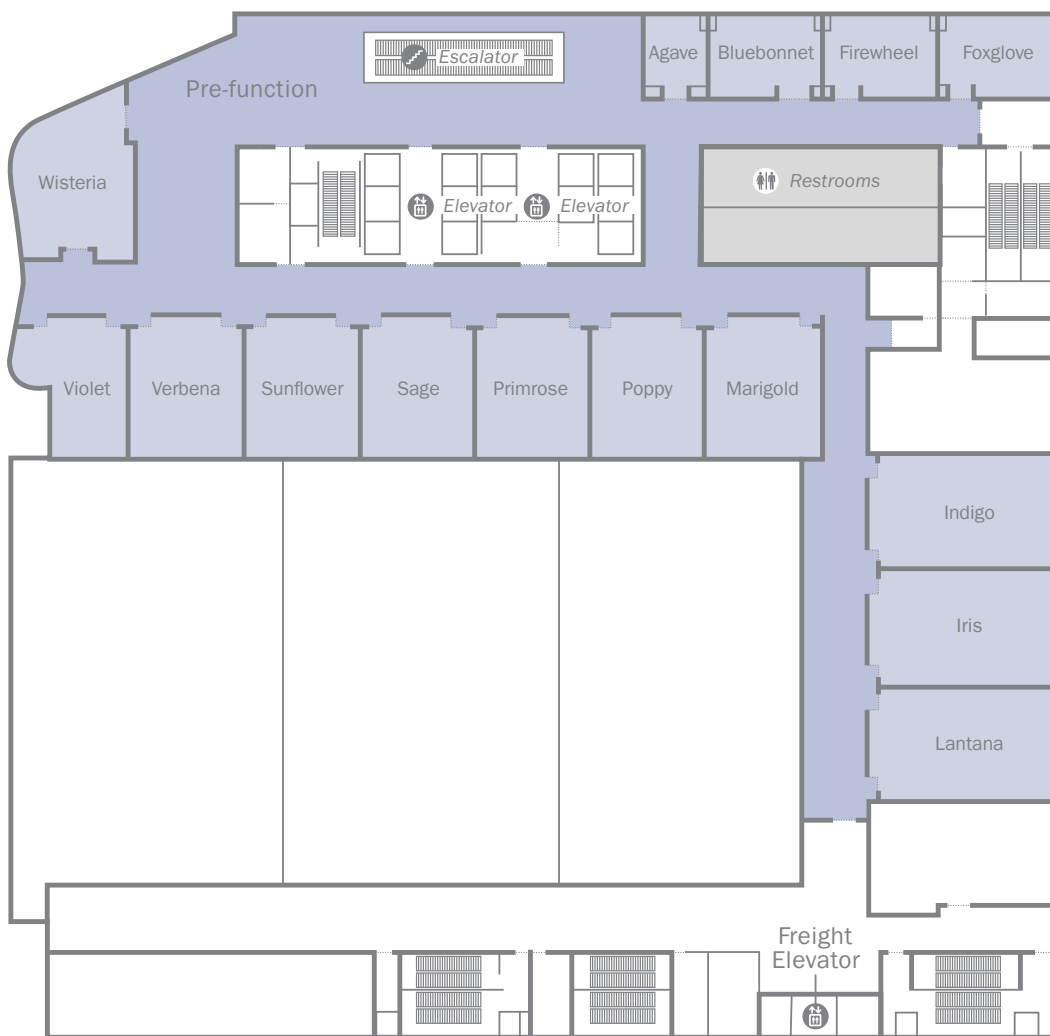

5TH FLOOR

MANCHESTER BALLROOM

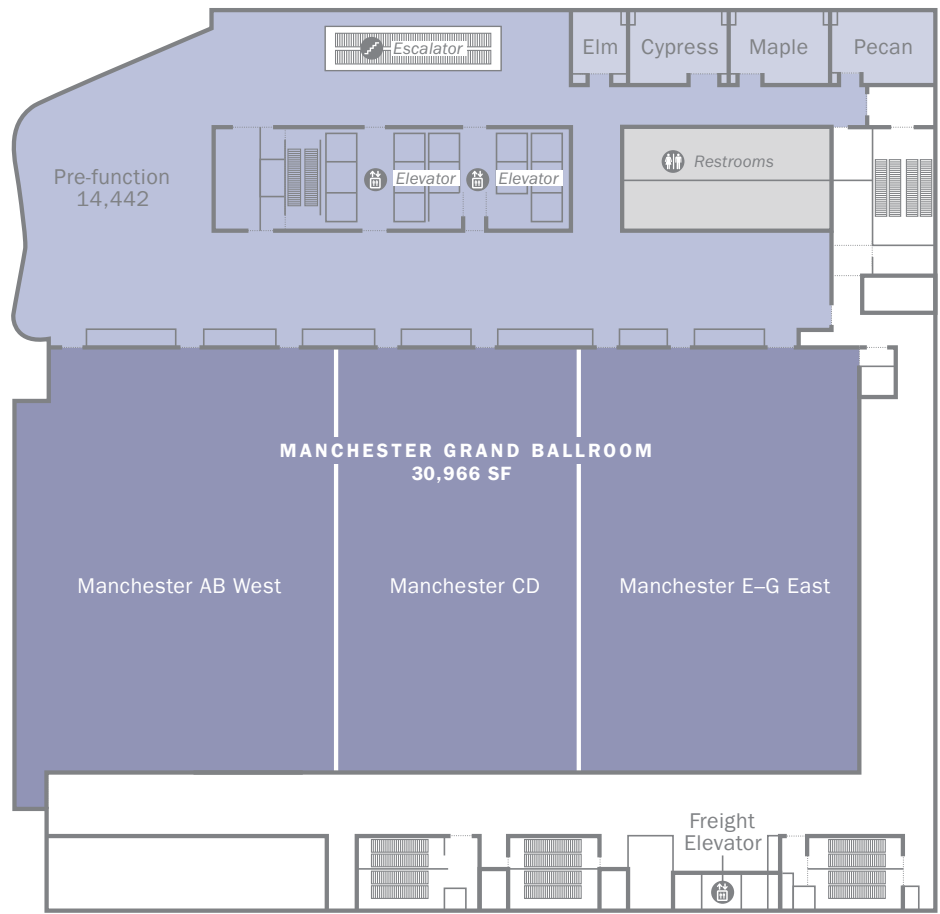

5TH FLOOR SEPARATED

MANCHESTER BALLROOM

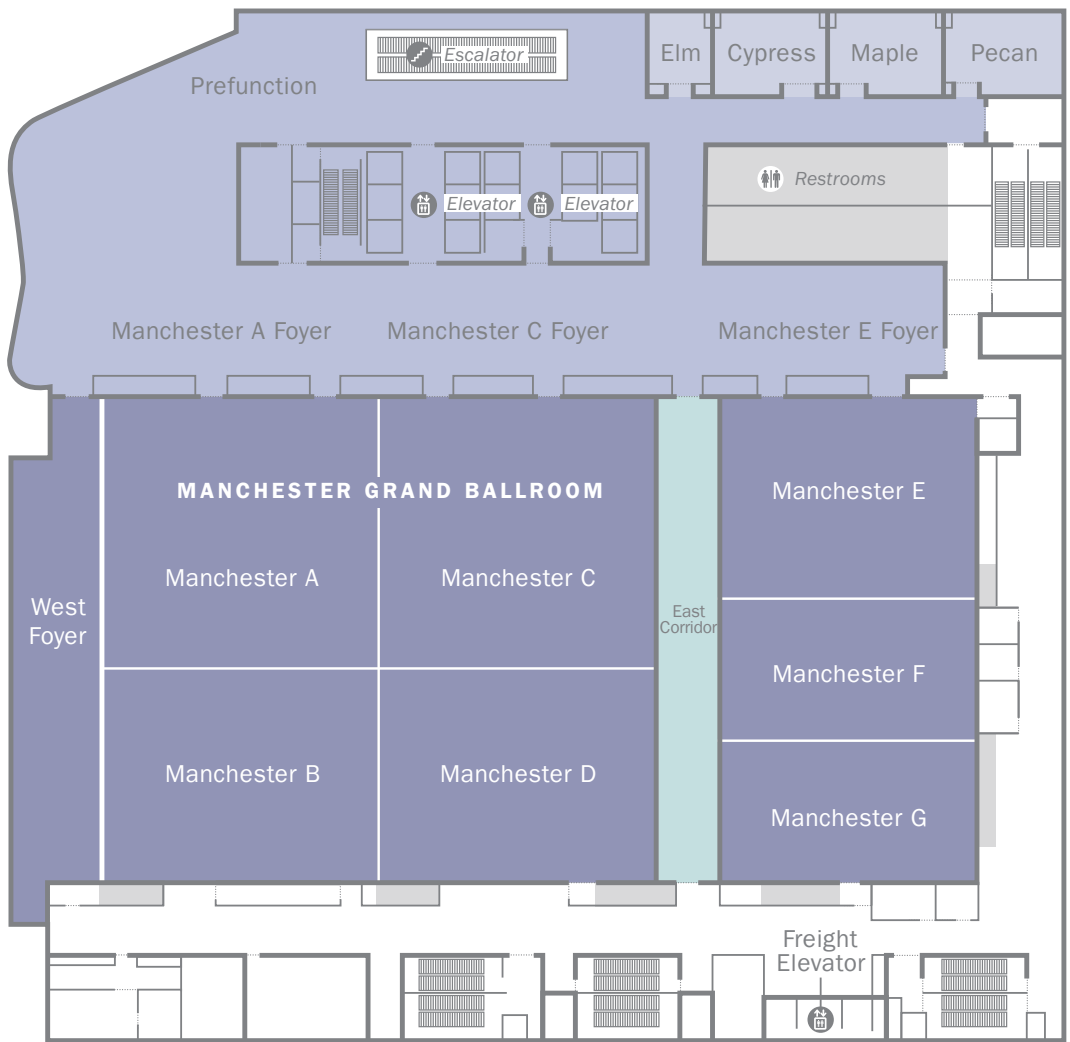

6TH FLOOR

SPA FAIRMONT

AMENITIES

- Cardio and Weights
- Men's and Women's Steam Room
- Men's and Women's Sauna
- Men's and Women's Whirlpool
- 9 Spa Treatment Rooms
- Men's and Women's Lounge and Locker Rooms
- Reception Area
- Salon

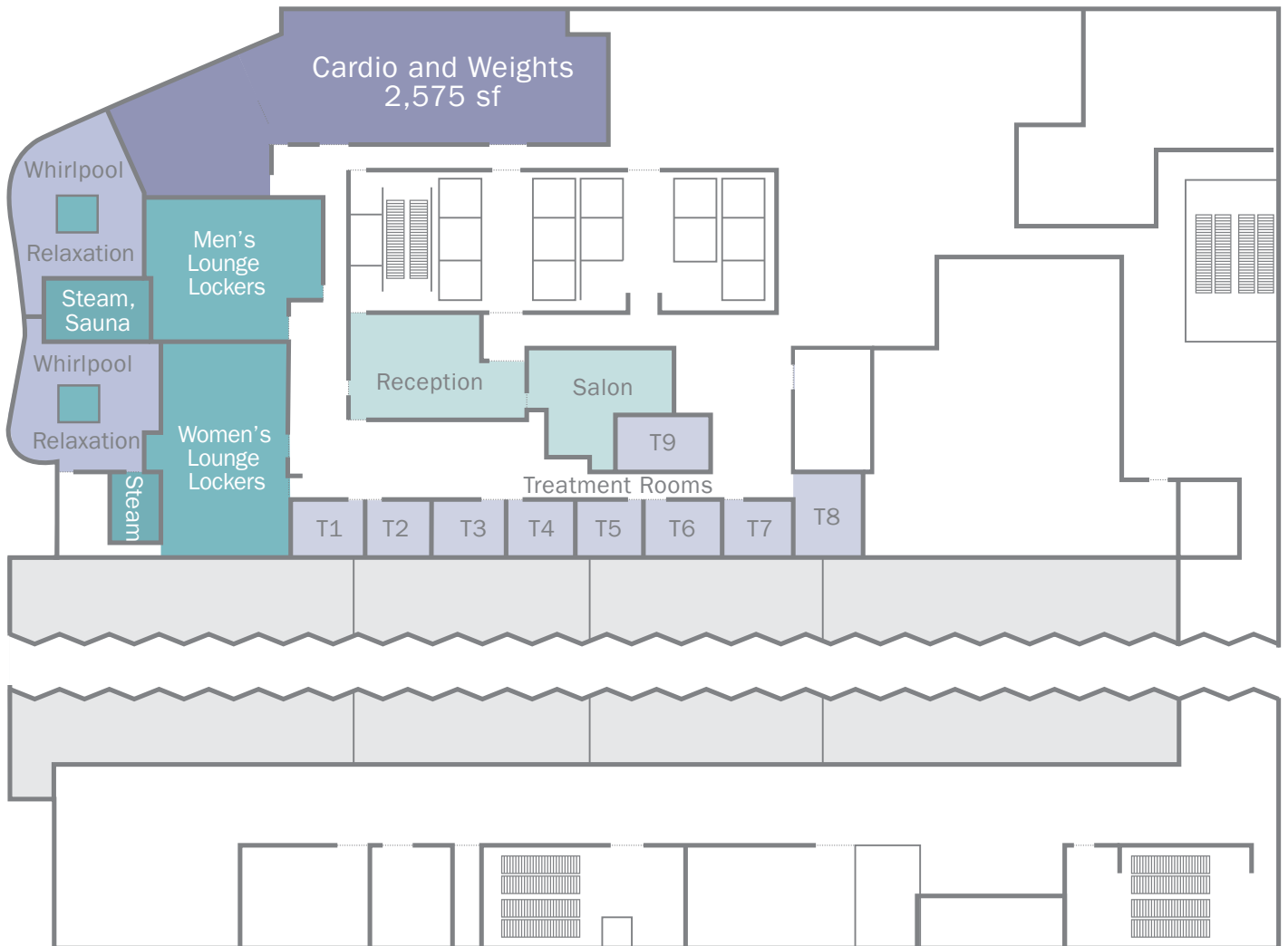

SCALE



100 feet

7TH FLOOR

ROOFTOP POOL & EVENT TERRACE

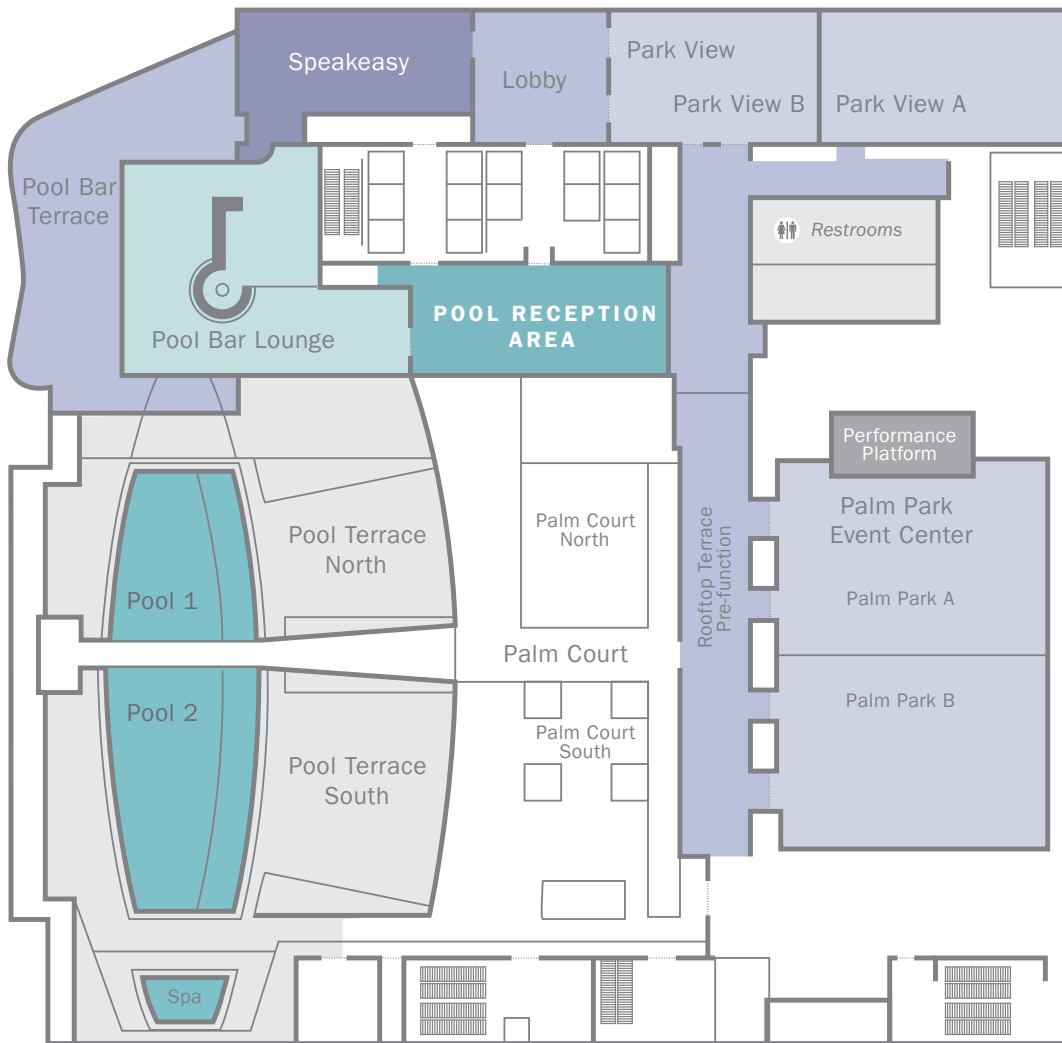

36TH FLOOR

PRESIDENTIAL SUITE, FAIRMONT GOLD ROOMS AND LOUNGE

AMENITIES

- 3,843 sf Gold Lounge
- 2,960 sf Presidential Suite
- 131 Gold Rooms

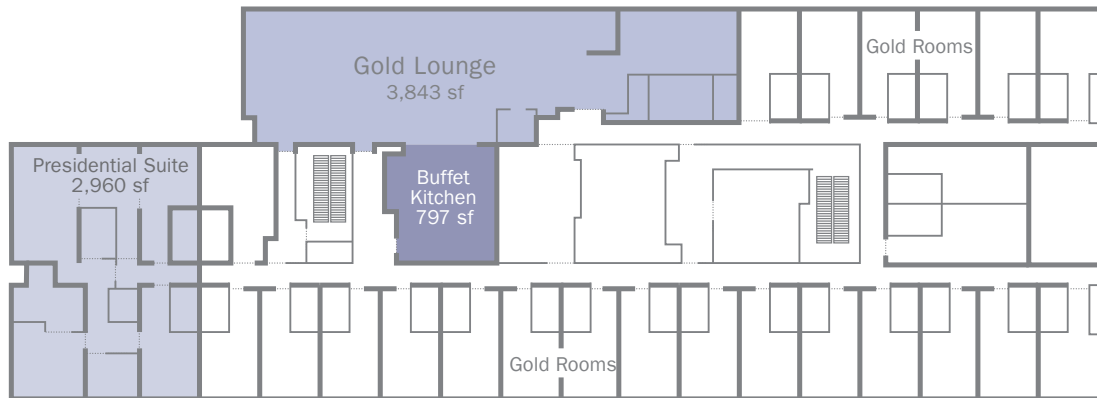

SCALE

